

はずる TM _®

H U Z Z L E

Huzzle Cast Enigma

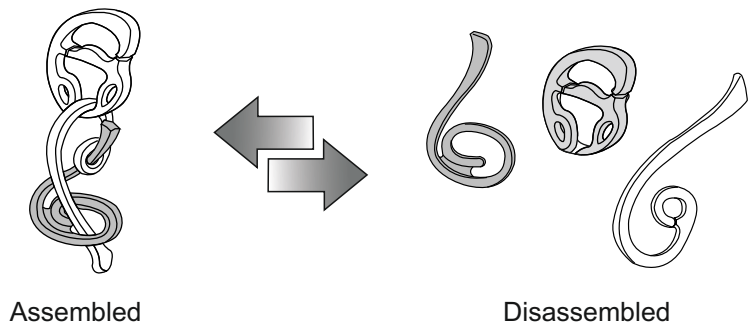

Start



Slide 3 downwards

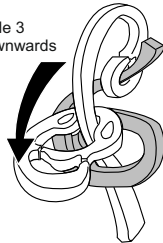

Rotate 3 180 degrees

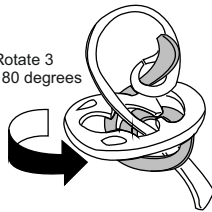

Slide the tab of 3 along the groove of 1

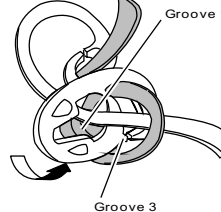

Groove 3

Rotate 3...

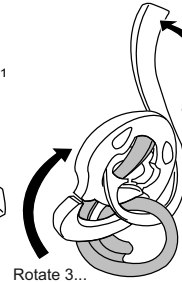

and lift 2



Shift 3 to the back

Align tab of 3 and notch of 1 and slide 3 down

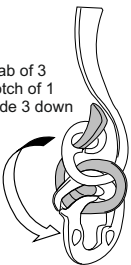

Rotate 3 180 degrees



Pull 2 down

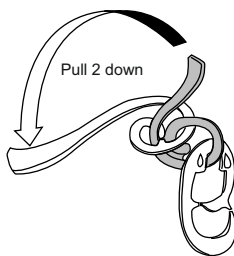

Rotate 2, passing it through 3

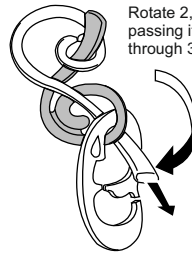

While lifting 2 up, rotate 3 180 degrees

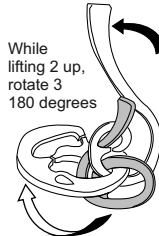

While pulling 3 towards to you....

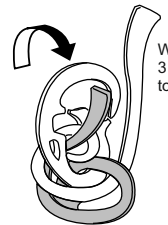

... lower 2 forward

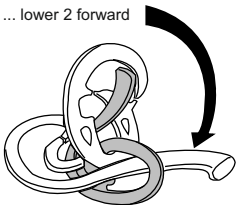

Rotate 2 180 degrees and line up the tab of 2 and the groove of 1

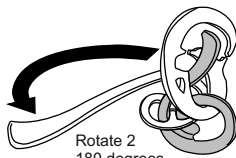

Slide 2 down

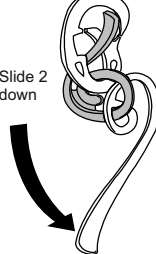

Slide 3 down

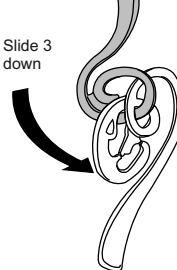

Rotate 3 180 degrees

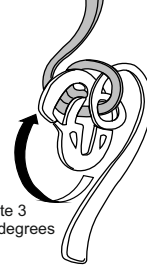

Line up the tab of 3 and the groove of 1 and slide 3 up



Rotate 3 90 degrees



Have 3 go over 1



Line up the tab of 3 and the groove of 1 and slide 3 backwards

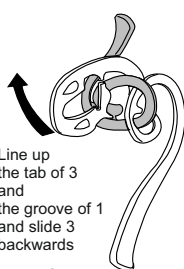

Doing so frees 3

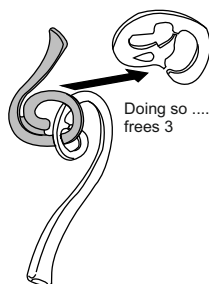

Lift 2 90 degrees

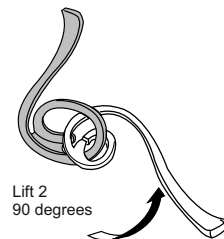

Rotate 2 90 degrees

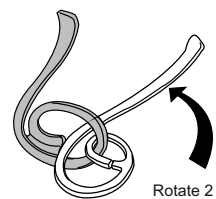

Use the place indicated below as a pivot and rotate 2 to change the position so that it can be pushed in

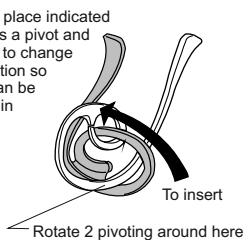

To insert

Rotate 2 further



Line up the tab of 2 and the groove of 1 and slide forward towards yourself

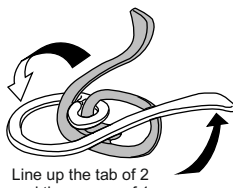

Do this

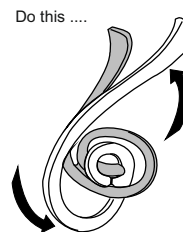

..... and they come apart.

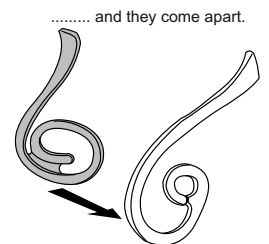

Designer: Eldon Vaughn (USA)

© 2004, 2018 Hanayama Co., Ltd.
All Rights Reserved



Exclusive European distribution
by Eureka bvba - 2800 Mechelen, Belgium